

# Solid Level Switch Type

## MDJ Series



Appearance

Sensing type

Retro-beam

Feature

The preferred alternative to mechanical float switches  
 Can detect water, oil, solvents, reagents and other viscous liquids  
 Positional repeatability up to 2mm, strong stability  
 Set NPN/PNP/Relay output in one, convenient connection  
 Stainless steel housing, withstands up to 1000 PSI pressure  
 Not affected by air bubbles, steam, impurities and turbulence  
 Epoxy resin sealed in one, highly reliable

Housing size	1/2" NPT	1/4" NPT
Repeat accuracy	≤2mm	
Delay	0.5s	
Input voltage	5~30 V DC	
Leakage current	≤50uA	
Output	Relay output: 0.5A single pole single throw (NO)	
Protective circuit	Transient voltage and polarity reversed	
Material	stainless steel (316L)	
Ambient temperature	-29°C~+80°C	
Environmental pressure	250PSI, customizable 500/1000PSI	
Lead length	12inch, (305mm)	
Model No.	<b>MDJ-C02-1/2</b>	<b>MDJ-C02-1/4</b>

### Dimensions

Unit: mm

#### MDJ-C02-1/2

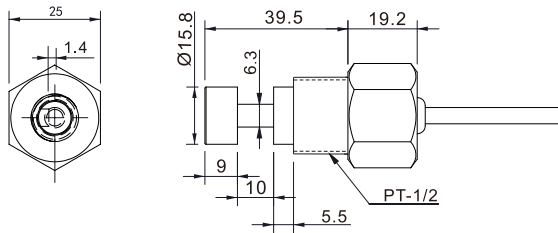

#### MDJ-C02-1/4

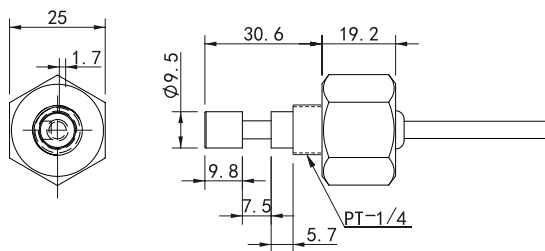

### Wiring Diagram

#### PNP

(Source current output)

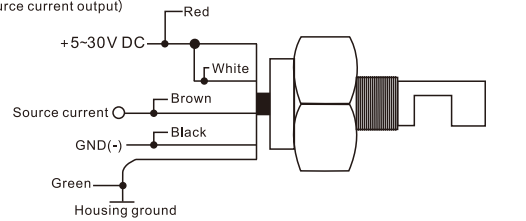

White line jumper connected to red line(+)

#### NPN

(Sink current output)

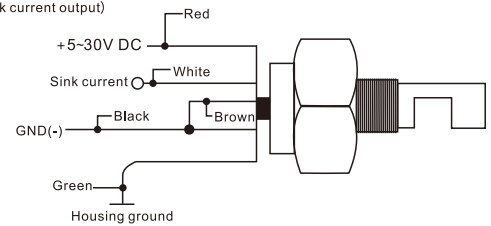

Brown line jumper connected to black line(-)

Relay current output

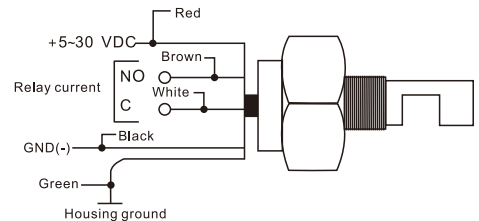

Guidance

Ultrasonic

Cylindrical type

Solid liquid level switches type

Fork type liquid level switch type

Double-sheet detection sensor